

**COMPETITOR SERIES®**

**C-BB48-HC**

**C-BB60-HC**

**C-BB72-HC**

# SOLID DOOR BACK BAR REFRIGERATORS

- Beautiful ergonomic construction
- Black corrosion resistant steel exterior, stainless steel interior and stainless steel top
- Digital temperature controller and read-out
- Forced air refrigeration system
- Side mount compressor
- Recessed door handles
- LED interior lighting
- Door locks
- Leveling feet included
- Accessory: optional casters upon request
- All Natural R290 Hydrocarbon Refrigerant
- US Department of Energy Certified
- Migali® Protection Plan: 2 Year Parts & Labor Warranty, 5 Years Compressor Warranty

| MODEL     | DOORS | CAPACITY CU/FT | STORAGE CAPACITY   | SHELVES | H/P | AMPS | VOLTAGE  | PLUG TYPE  | TEMP RANGE           | EXTERIOR DIMENSIONS W X D X H | INTERIOR DIMENSIONS W X D X H | PACKAGED DIMENSIONS W X D X H | WEIGHT   | PACKAGED WEIGHT |
|-----------|-------|----------------|--|---------|-----|------|----------|------------|----------------------|-------------------------------|-------------------------------|-------------------------------|----------|-----------------|
| C-BB48-HC | 2     | 13             | 546 (12 oz.) cans<br>336 (12 oz.) bottles<br>2 (1/2 barrel) kegs | 4       | 1/5 | 2.8  | 115/60/1 | Nema 5-15P | +33° F (-)<br>+38° F | 48.75 x 24.4 x 35.7           | 36.25 x 18.5 x 28.9           | 51.25 x 27.5 x 41.75          | 231 lbs. | 282 lbs.        |
| C-BB60-HC | 2     | 17.3           | 756 (12 oz.) cans<br>456 (12 oz.) bottles<br>2 (1/2 barrel) kegs | 4       | 1/5 | 2.8  | 115/60/1 | Nema 5-15P | +33° F (-)<br>+38° F | 60.75 x 24.5 x 35.7           | 48.25 x 18.5 x 29             | 63.5 x 27.5 x 41.75           | 276 lbs. | 319 lbs.        |
| C-BB72-HC | 3     | 21.6           | 966 (12 oz.) cans<br>576 (12 oz.) bottles<br>3 (1/2 barrel) kegs | 6       | 1/3 | 3.96 | 115/60/1 | Nema 5-15P | +33° F (-)<br>+38° F | 72.75 x 24.5 x 35.7           | 60.2 x 18.5 x 31.5            | 75.25 x 27.5 x 41.75          | 331 lbs. | 374 lbs.        |

**Accessories:**

- Caster - stem - with brake ( 5-3/4" overall) - Part Number 1597-01
- Caster - plate - with brake ( 5-1/4" overall) - Part Number 2481-329

**FOR COMMERCIAL USE ONLY**
**NOTE: MIGALI® RESERVES THE RIGHT TO CHANGE SPECIFICATIONS WITHOUT NOTICE**

**TOLL FREE: 800.852.5292**  
**WEB: www.migali.com**

# DIMENSIONAL DRAWINGS

**C-BB48-HC**

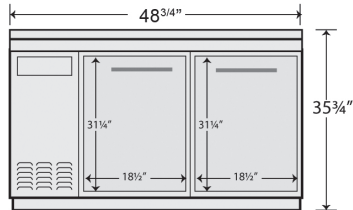

**C-BB60-HC**

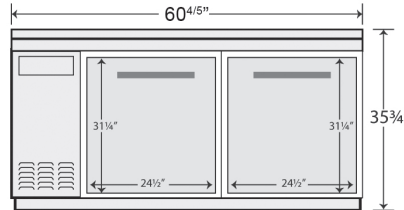

**C-BB72-HC**

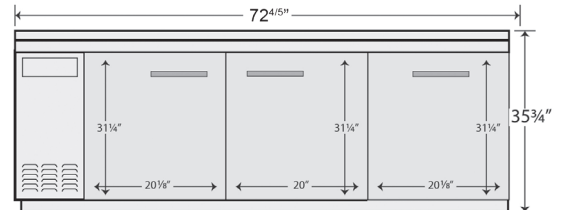

**C-BB48-HC  
TOP VIEW**

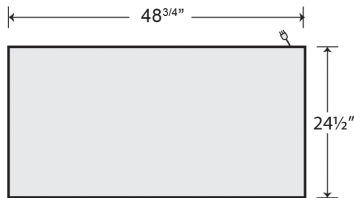

**C-BB60-HC  
TOP VIEW**

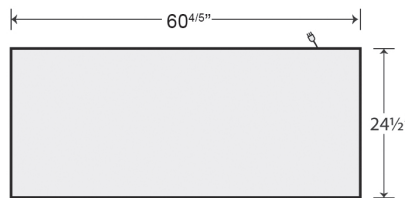

**C-BB72-HC  
TOP VIEW**

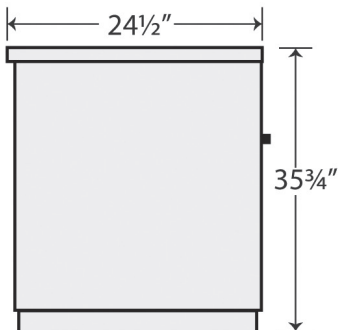
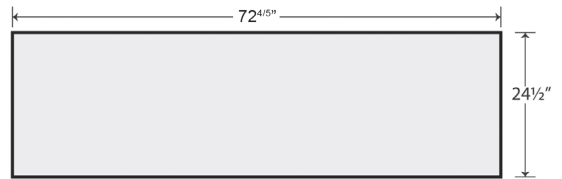

**SIDE VIEW (1,2,3) DOOR MODELS**



MIGALI® REMAINS AN AMERICAN FAMILY COMPANY SINCE 1955